

APPLICATION

Note: For graphics larger than poster size, we recommend contacting a professional graphics installer for assistance.

General Instructions

Please review the General Instructions and Method: Horizontally-oriented Graphics or Method: Vertically-oriented Graphics before applying this film.

Surface Preparation

Windows must be thoroughly cleaned and dried before this film is applied.

The installer must determine whether the window has a low surface energy coating. To do this, splash water on the window; if it beads up, it has a coating. To help ensure good adhesion of the film to the window, the installer should clean the window with a low abrasive cleaner such as Soft Scrub or Bon Ami Window Cleaner. This should remove any coating that may affect film adhesion.

General Instructions

Two people are required to apply most graphics. Notice the dark and light hands in the illustrations.

Tools

- 1" wide masking tape
- Razor blade in a safety handle, or scissors
- 3M Applicator PA-1 (blue or gold); also called a "squeegee"
- 3M Low Friction Sleeve SA-1

Special Handling for Graphics Made with Media 8604 ES or 8605 ES

Any tape applied to the imaged side of media 8604 ES or 8605 ES may lift off the toner and wear coat when the tape is removed. This applies to tape used in making overlaps, for alignment or simply holding graphics in place prior to application.

Liner Removal Technique

Use two hands when pulling the liner from the film, using care not to stretch the film.

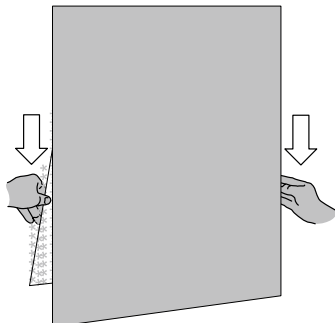

Application Technique

- Use a 3M squeegee with a paper sleeve
- Pull the squeegee with your hand, don't push the across the graphic, which stretches the film.
- Stroke in a straight line-not in an arc.
- Use firm, overlapping strokes.
- Re-stroke all edges after applying the graphic.

Squeegee with paper sleeve

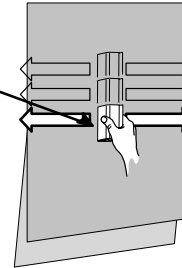

Maintenance and Cleaning

Refer to Instruction Bulletin 6.5.

Removal

Using two hands, start at the top of the graphic and pull it down slowly at a 120 to 180 degree angle.

Any residual haze on the window can usually be removed by wiping it with a clean, dry cloth. If necessary, also use a household window cleaning product.

See Instruction Bulletin 6.5 for more details.

Shelf Life, Storage and Shipping

Shelf Life

- Unprocessed: up to 24 months after receipt from 3M.
- Processed but unapplied: 12 months or less (see Example).
- Total as processed and unprocessed: not to exceed 24 months.

EXAMPLE: If the film was stored for 16 months before processing, it must be applied within 8 months after processing.

Storage

- Store the film in a clean, dry area in the original container.
- Store the film out of direct sunlight and at less than 100 (38°C).

Shipping

- Ship the finished graphic lying flat or in a roll. To roll the graphic, roll it film side out onto a core that is 6 inches (15 cm) or larger in diameter. These methods help prevent the film and application tape from wrinkling or popping off the liner.

APPLICATION METHOD 2

Orientation: Horizontal (graphic is wider than it is tall)
Imaging Method: Screen printed, Offset printed (see Method 3 also)

Please review the General Instructions and this Method before applying the film.

